

# Ambassador SERIES



Providing the widest selection of quality vinyl and aluminum window & door products.

**INTERNATIONAL  
WINDOW**

# Ambassador 8200 SERIES

The Ambassador Series, which features our innovative Isobar ThermoTech™ design, is a high-performance aluminum window that is energy efficient as well as meets the color requirements of an interior designer. With its dual design extrusions, you can mix earth tones on the outside with neutral colors on the inside. When energy efficiency is a priority or requirement, the Ambassador Series can meet these demands.



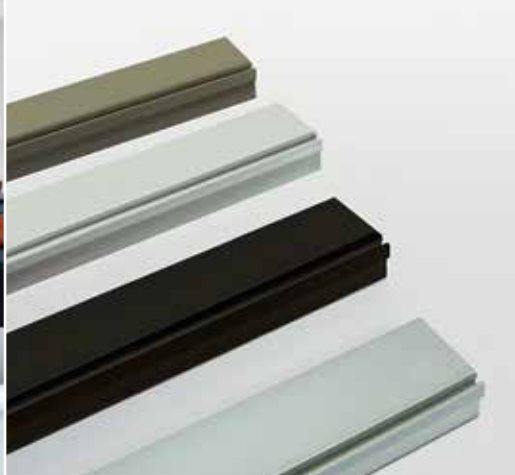

## Dual Color Options: Our ThermoTech process enables you to match to both exterior & interior color schemes

*J = Mojave Beige*

*W = White Paint*

*P = Bronze Anodized*

*A = Clear Anodized*

*\*For Dual Color options, specify exterior / interior finish ( i.e. J / W )*

## IMPORTANT POINTS AND KEY FEATURES

### • Frame Options:

*1-3/8" Nail-On Frame*

*Block Frame*

*Retro-Fit Frame*

### • 2-3/4" Frame Depth

### • State of the art Isobar ThermoTech Extrusions

*Nail-On and Block Frames are 1/2" under callout size. Retro-Fit Frame is net frame dimension.*

### • Double Fin-seal Weatherstripping on full Perimeter of Vent

### • Notched Corners for added strength and durability

### • Anti-lift sash blocks

### • Weephole Covers

### • Clean Design and Even Sight Line

### • Lifetime Warranty

## ThermoTech™ Extrusions - Fully thermally broken to achieve maximum energy performance

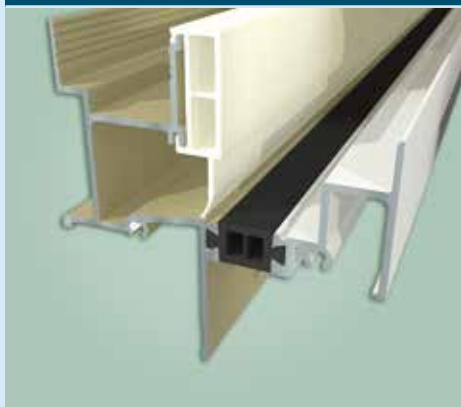

### New innovative windows from International Window

Tired of looking at dark frames against your white walls? Can't achieve that Southwestern look on your home's exterior with white frames? Look no further. The Dual Design of the Isobar ThermoTech™ extrusions allows you to achieve the designer look you desire.

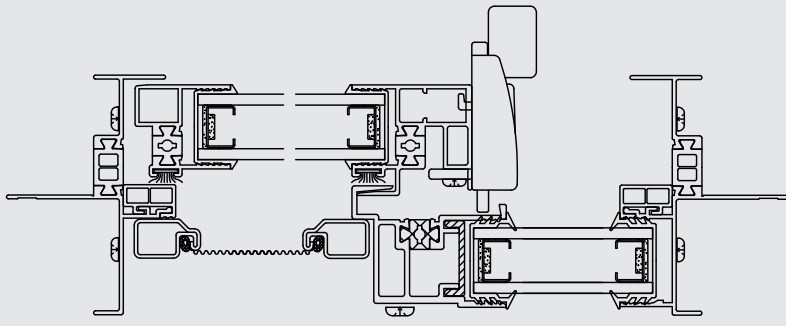

Horizontal Detail

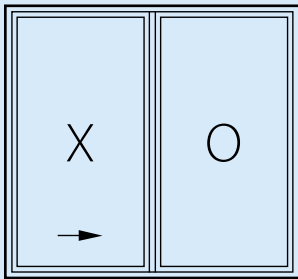

XO

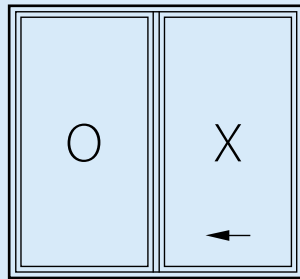

OX

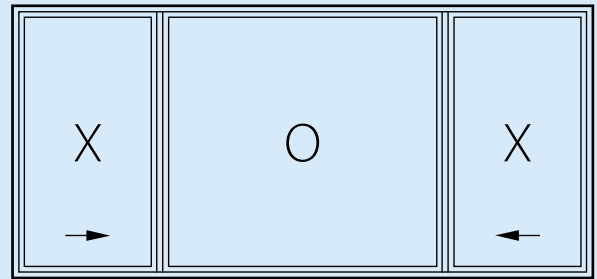

XOX

## Horizontal Sliding Window

### HORIZONTAL SLIDING FEATURES



**Adjustable Delrin Rollers**  
Smooth Operation

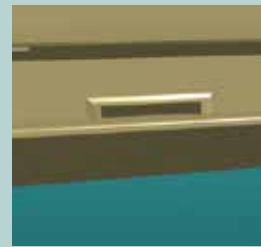

**Weep Hole Covers**  
Reduces wind & debris

- *3/4" Dual Glazing*
- *2-3/4" Frame Depth*
- *Retro-Fit Frame Available*

- *Clean Design and Even Sight Line*
- *Anti-Lift Sash Blocks*
- *Handed Latches - locked in "down" position*



## Casement Configurations

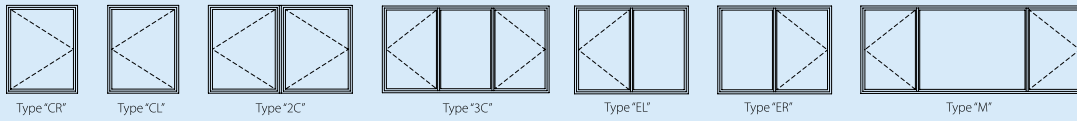

## Awning Configuration

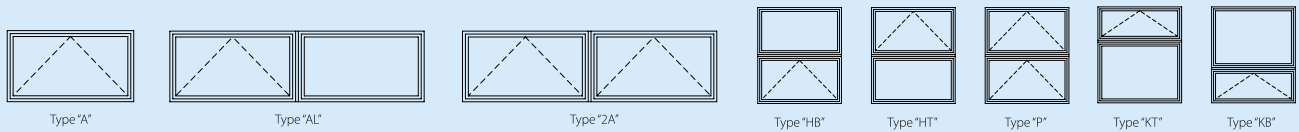

# Casement & Awning Window



**Full-Flip Nesting Handle**

- **1" Dual Glazing**
- **2-3/4" Frame Depth**
- **Butt Hinges-Allows for larger sizes**
- **Features a standard folding handle**
- **Aluminum Extruded Screen**
- **Retro-Fit Frame Available**

**Casement Detail**

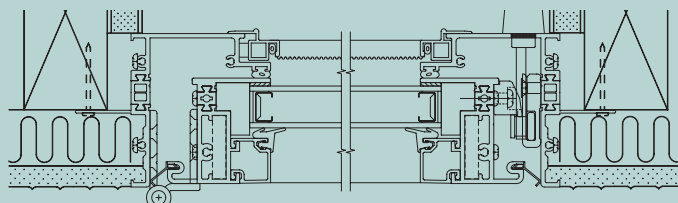

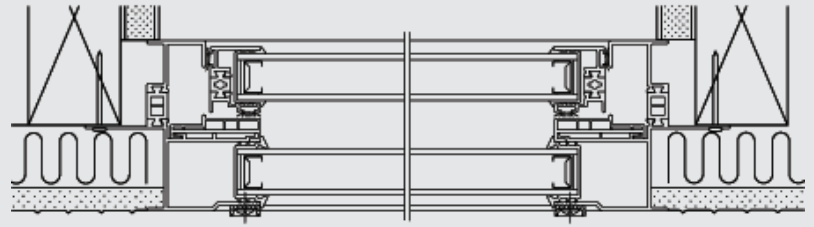

Single Hung Detail

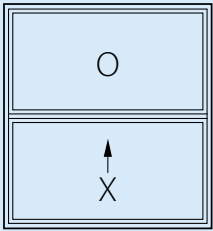

1/1 Single Hung

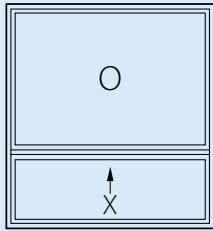

1/3 Vent

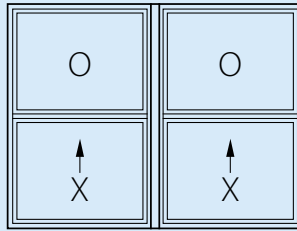

Twin 1/1 by 1/1

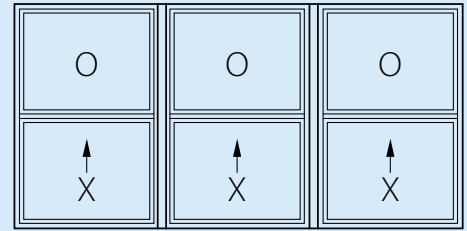

Triple 1/1 by 1/1 by 1/1

## Single Hung Window

### SINGLE HUNG FEATURES



**Tilt-in Sash**



**Cam Latch**

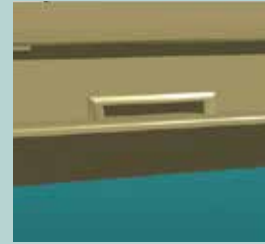

**Sloped Sill w/ Weep Hole Cover**

- *3/4" Dual Glazing*
- *Clean Design and Even Sight Line*
- *Retro-Fit Frame Available*

- *Block & Tackle Balancers*
- *Tilt in sash for ease of cleaning*

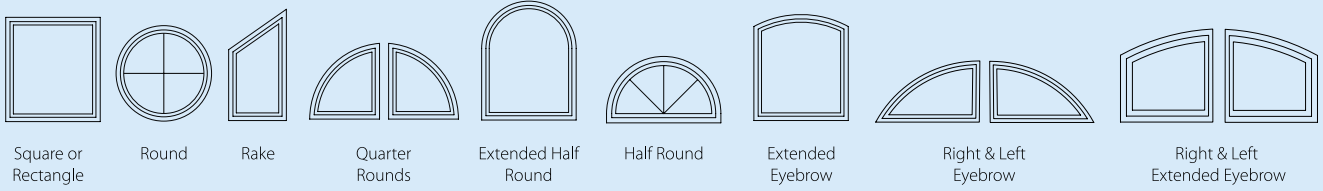

# Picture Window & Special Shapes

- 1" Dual Glazing
- Clean Sightlines
- Meets Light Commercial ratings
- Exterior Aluminum Extruded Stops

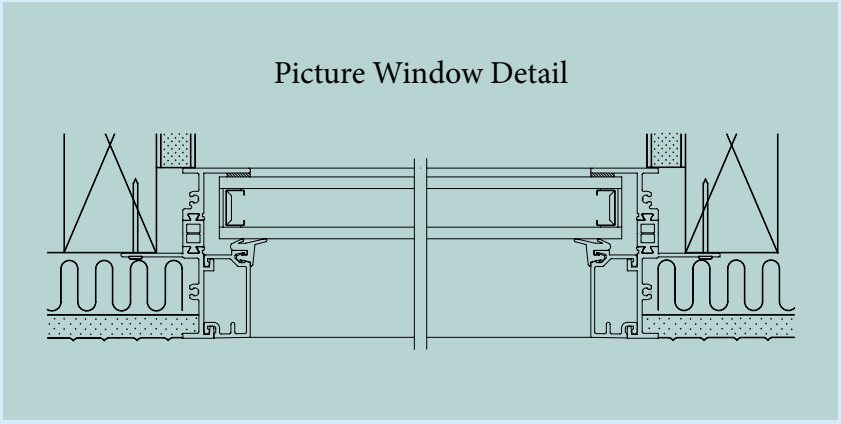
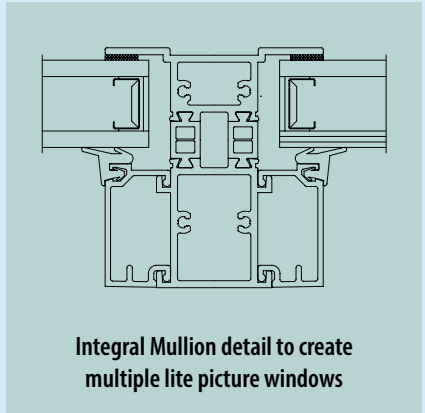
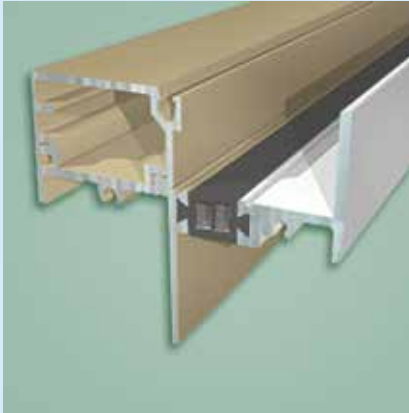



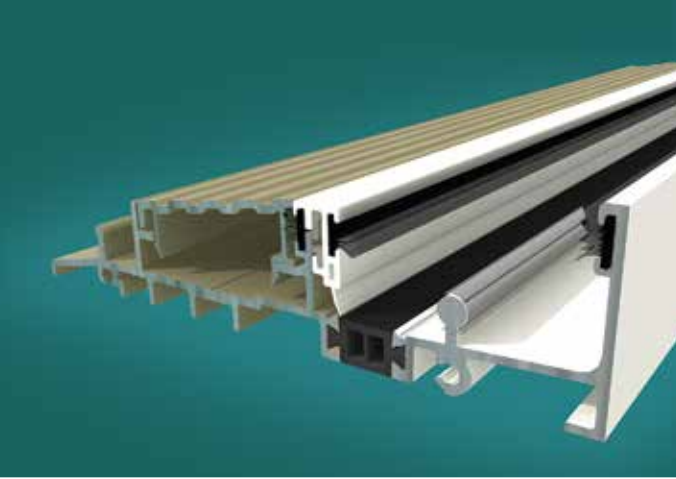

### Sliding Door Detail

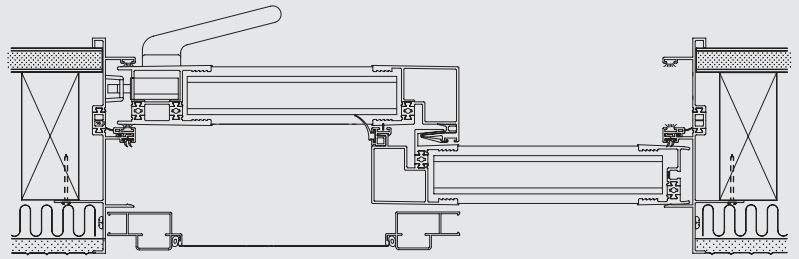

2 PANEL DOORS

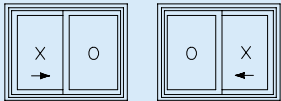

XO

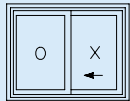

OX

3 PANEL DOORS

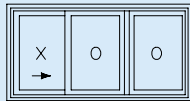

XOO

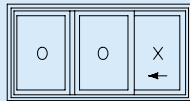

OOX

4 PANEL DOORS

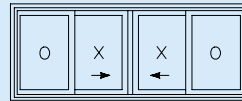

OXXO

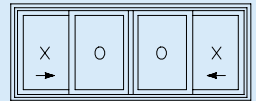

XOOX

## 8900 Ambassador Sliding Glass Door

- Std 1-13/16" Dia Sealed Ball Bearing rollers
- Optional stainless Steel Rollers
- Handle Hardware available in 4 finishes - Black, Silver, White and Mojave Beige
- Dual Finish Available
- 1" Dual Glazing
- Optional Key Lock
- Retro-Fit Frame Available



### Attractive "C" Handle

All doors include a mortise recessed lock system with an ergonomically designed "C" handle. This lock has been tested to CAWM's rigorous security standard that meets or exceeds all local jurisdictions.

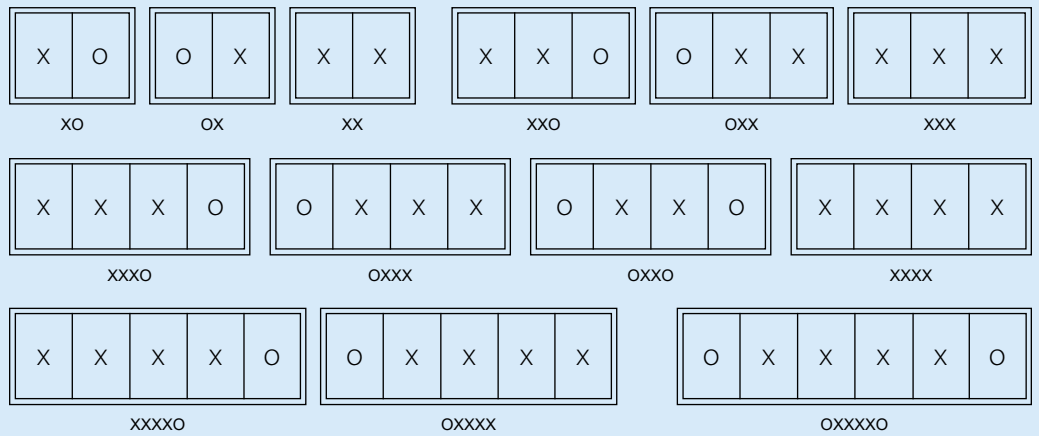



Quad Roller and Flush Handle are standard features of the 8881

**8880 Product Features:**

- Block Frame
- White Paint, Mojave Beige Paint, Clear Anodized and Bronze Anodized
- 1" O.A. Glass Package
- Standard Low-E or upgrade to Low-E Extreme
- 1 13/16" Tandem Rollers
- Stainless Steel Rollers available
- Attractive "C" Handle
- Surface Mount Sill
- Sill Pan
- 8800 Panel sizes up to 4' X 9'
- Screens Optional

**8881 Product Features:**

- Block Frame
- White Paint, Mojave Beige Paint, Clear Anodized and Bronze Anodized
- 1" O.A. Glass Package
- Standard Low-E or upgrade to Low-E Extreme
- Stainless Steel Quad Roller
- Flush Pull Handle - Available in black and brushed nickel finish
- Surface Mount Sill
- Sill Pan
- 8881 Panel sizes up to 5' X 10'
- Screens Optional

## 8880 and 8881 Ambassador Multi-Slide Doors

Designers and Architects love the thermal values that the 8880 and 8881 provide, while homeowners embrace the slim lines that afford them the beautiful views of their world. IWC has designed a product that is truly your "Window to the World".

Whether your view is of the ocean, the desert, or the mountains, you'll view it beautifully through the Ambassador Multi-Slide. A true luxury door that affords you the ability to enjoy your views while helping to keep you cozy in the winter and more comfortable in the summer.

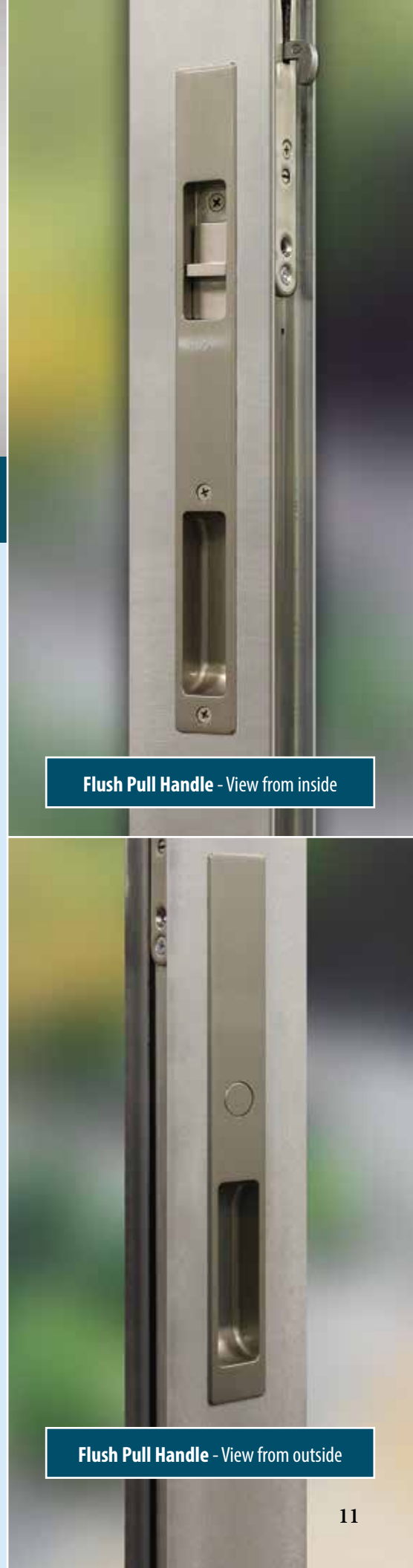

Flush Pull Handle - View from inside

Flush Pull Handle - View from outside

International Window Company

[www.intlwindow.com](http://www.intlwindow.com)

IWC - Southern California  
IWC - Northern California

2455 Wardlow Road Corona, CA 92878  
1320 Performance Drive Stockton, CA 95206

Ph: 1.800.477.4032  
Ph: 1.800.624.0990

